









Q.Safe

MQS-SH

SCREW VERY HIGH PRESSURE

					
SIZE	WORKING PRESSURE (Dynamic)	RATED FLOW at 0,2MPa of pressure drop	OIL SPILLAGE Connection/ Disconnection	MINIMUM BURST PRESSURE (MPa)	CONNECTION / DISCONNECTION UNDER PRESSURE

mm	inch	dash	MPa	PSI	L/min.	US GPM	cc.	cubic inch	Male		Female		M+F		
									MPa	PSI	MPa	PSI	MPa	PSI	
10	3/8"	-06	70	10150	31	8,2	1,5	0,092	250	36250	330	47850	320	46400	Allowed max. 30Mpa
12,5	1/2"	-08	70	10150	51	13,5	2,2	0,134	220	31900	240	34800	310	44950	Allowed max. 30Mpa
20	3/4"	-12	65	9425	102	26,9	4	0,244	200	29000	250	36250	310	44950	Allowed max. 30Mpa
25	1"	-16	60	8700	170	44,9	7,5	0,458	200	29000	230	33350	270	39150	Allowed max. 30Mpa

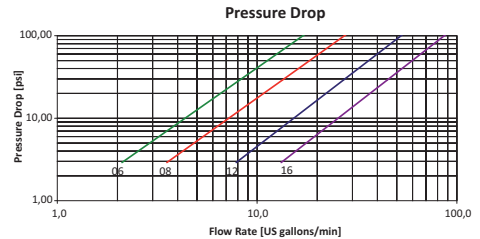
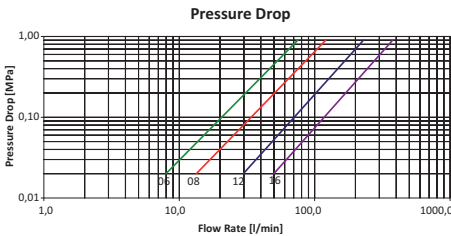

Screw-on connection/disconnection system ■ Sleeve with hexagon area Internal components reinforced, made in steel ■ Hardened valve bodies ■ Three-part poppet valve with a moulded shaped seal ■ Mechanical backstop to prevent partial enclosures of valves due to peaks and reverse flow ■ Interchangeable with other products and widely used in the market ■ Accessories (plugs and caps) and spare parts kits available ■ Wide range of termination end

Sistema de conexión y desconexión roscado ■ Casquillo de acero hexagonal con componentes internos reforzados ■ Cuerpo de la válvula endurecido ■ Válvula de punzon en 3 partes con juntas de estanqueidad ■ Bloques mecánico de la válvula para eliminar el riesgo del cierre del paso del aceite debido a los picos de presión y la inversión del flujo ■ Intercambiabilidad con productos existentes en el mercado ■ Disponibilidad de tapones de protección y kit de recambios ■ Amplia gama de roscas

Schraubkupplung ■ Verbindungsmuffe mit Sechskant ■ Innenteile aus verstärktem Stahl ■ Gehärtete Ventiltteile ■ Dreiteiliges Rückschlagventil mit Spritzformdichtung ■ Mechanischer Anschlag verhindert unbeabsichtigtes Öffnen des Ventils durch Rückfluss oder Druckspitzen ■ Austauschbar mit anderen weit verbreiteten ähnlichen Produkten ■ Zubehör (Schutzkappen und Stopfen) und Ersatzteilkits sind verfügbar ■ Breites Angebot an Anschlussausführungen

Connessione e disconnessione a vite ■ Ghiera con profilo esagonale Componenti interni rinforzati ■ Valvole trattate termicamente ■ Sistema di tenuta poppet in 3 parti con guarnizione elastomerica sagomata ■ Blocco meccanico delle valvole per eliminare il rischio di parziale chiusura del passaggio di olio dovuto a picchi di portata ed inversioni del flusso ■ Intercambiabilità con prodotti esistenti sul mercato ■ Disponibili Tappi di protezione e kit di ricambio ■ Amplia gamma di terminali filettati

TECHNICAL INFO

GB

MATERIAL:

Couplings in steel with some stressed area hardened, carbonitrided valve, springs in C98 steel, seals in NBR, back-up ring PTFE

WORKING TEMPERATURE:

-22°F up to +230°F -30°C up to +110°C

SAFETY FACTOR:

1:3 for dynamic pressures and 1:2 for static ones

IMPULSE PRESSURES:

500.000 cycles (connected and disconnected conditions) at 120% of the rated one (freq.1Hz)

TEST SPECIFICATIONS:

ISO 7241-2

ES

MATERIAL:

Acoplamiento de acero con algunas zonas endurecidas, valvula carbonitrada, muelles en acero C98 juntas en NBR, anillo de soporte PTFE

TEMPERATURA DE TRABAJO:

-22°F hasta +230°F -30°C hasta +110°C

(para otras temperaturas, el acoplamiento puede ser montado con juntas específicas)

FACTOR DE SEGURIDAD:

1:3 para presiones dinámicas y 1:2 para presiones estáticas

PRESIONES DE IMPULSO:

500.000 ciclos (conexión y desconexión) a 120% presión ejercicio (FREC. 1Hz)

CARACTERÍSTICAS DE LA PRUEBA:

ISO 7241-2

D

MATERIAL:

Kupplungsteile aus Stahl, beanspruchte Flächen gehärtet, Carbonitriertes Ventil, Feder aus C98, Dichtungen NBR, Sicherungsring aus PTFE

BETRIEBSTEMPERATUR:

-22°F bis +230°F -30°C bis +110°C

SICHERHEITSAKTOR:

1:3 für dynamischen und 1:2 für statischen Druck

DRUCKIMPULSE:

500.000 Zyklen (im verbundenen und auch getrennten Zustand) bei 120% des angegebenen Druckes

TEST SPECIFICATIONS:

ISO 7241-2

IT

MATERIAL:

Parti dell' innesto in acciaio al carbonio con zone sollecitate trattate termicamente, valvole carbonitrate, molle in C98, guarnizioni: NBR antiestusione: PTFE

TEMPERATURE DI ESERCIZIO:

-22°F a +230°F -30°C a +110°C

(per temperature diverse, l'innesto rapido viene fornito con guarnizioni appropriate)

FATTORE DI SICUREZZA:

1:3 per pressioni dinamiche e 1:2 per pressioni statiche

RESISTENZA A PRESSIONI PULSANTI:

500.000 cicli (sia accoppiato che disaccoppiato) a 1Hz al 120% della pressione di esercizio

TEST: ISO 7241-2

SIZE		TIGHTENING TORQUE (male/female)	
------	--	------------------------------------	--

mm	inch	dash	Nm
10	3/8"	- 06	70
12,5	1/2"	- 08	100
20	3/4"	- 12	150
25	1"	- 16	250

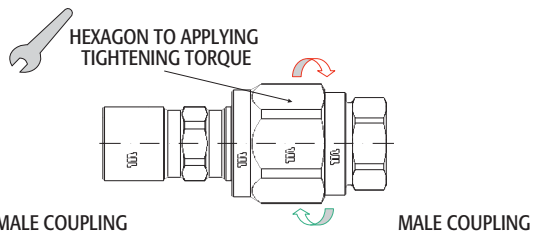

SCREW VERY HIGH PRESSURE - TERMINATION ENDS

BSP

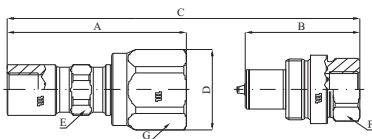

Q05411041A - Q05311041A

BSP TERMINATION ENDS TO DIN 3852 X TYPE
 ROSCA BSP PARA DIN 3852 TIPO X
 BSP-ENDSTÜCKE NACH DIN 3852 X TYPE
 TERMINALI BSP A NORMA DIN 3852 FORMA X

SIZE			PART NUMBER	THREADS	DIMENSIONS mm							
mm	inch	dash	Female Coupling	Male Coupling		A	B	C	D	E	F	G
10	3/8"	-06	Q05411041A-06-06	Q05311041A-06-06	3/8"	72,5	46,2	A+B-25,9	ø38,5	22	27	35
12,5	1/2"	-08	Q05411041A-08-08	Q05311041A-08-08	1/2"	82,1	54,4	A+B-27,3	ø45,0	27	32	41
20	3/4"	-12	Q05411041A-12-12	Q05311041A-12-12	3/4"	93,7	61,4	A+B-31,9	ø55,0	35	41	50
25	1"	-16	Q05411041A-16-16	Q05311041A-16-16	1"	105,8	68,3	A+B-37	ø66,0	41	50	60

NPT

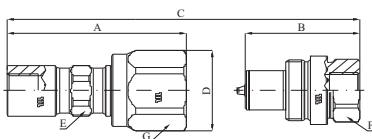

Q05411341A - Q05311341A

NPTF TERMINATION ENDS TO ANSI B 1.20.3
 ROSCA NPTF PARA ANSI B 1.20.3
 NPTF-ENDSTÜCKE NACH ANSI B 1.20.3
 TERMINALI NPTF A NORMA ANSI B 1.20.3

SIZE			PART NUMBER	THREADS	DIMENSIONS mm							
mm	inch	dash	Female Coupling	Male Coupling		A	B	C	D	E	F	G
10	3/8"	-06	Q05411341A-06-06	Q05311341A-06-06	3/8" NPTF	72,5	46,2	A+B-25,9	ø38,5	22	27	35
12,5	1/2"	-08	Q05411341A-08-08	Q05311341A-08-08	1/2" NPTF	82,1	54,4	A+B-27,3	ø45,0	27	32	41
20	3/4"	-12	Q05411341A-12-12	Q05311341A-12-12	3/4" NPTF	93,7	61,4	A+B-31,9	ø55,0	35	41	50
25	1"	-16	Q05411341A-16-16	Q05311341A-16-16	1" NPTF	105,8	68,3	A+B-37	ø66,0	41	50	60