

Adattatore di prolungamento: Tipo 3108--

SPECIFICHE TECNICHE

Acciaio Inox Tipo 31****
Norme BS-5200
Filetto Gas cilindrico

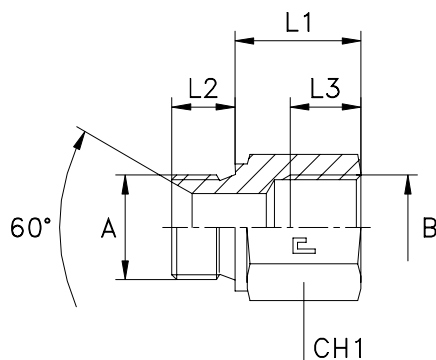

Codice	A	B	L1	L2	L3	CH1	BAR
310801	1/8	1/8	18	8	10	14	8
310802	1/8	1/8	28	8	10	14	8
310803	1/8	1/8	38	8	10	14	8
310804	1/4	1/4	18	11	14	19	8
310805	1/4	1/4	27	11	14	19	8
310806	1/4	1/4	40	11	14	19	8
310807	1/4	1/4	45	11	14	19	8
310808	3/8	3/8	18	12	14	22	8
310809	3/8	3/8	31	12	14	22	8
310810	3/8	3/8	36	12	14	22	8
310811	3/8	3/8	43	12	14	22	8
310812	1/2	1/2	20	14	17	27	8
310813	1/2	1/2	23	14	17	27	8
310814	1/2	1/2	33	14	17	27	8
310815	1/2	1/2	43	14	17	27	8
310816	1/2	1/2	63	14	17	27	8
310817	3/4	3/4	29	16	19	36	8
310818	3/4	3/4	37	16	19	36	8