

Croce intermedia: Tipo 1140--.B

SPECIFICHE TECNICHE

Acciaio Inox Tipo 11****.B
Norme DIN 2353

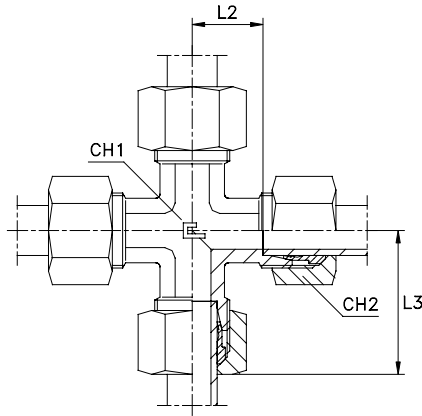

Codice	Ø Tubo	L2	L3	CH1	CH2	BAR
114004.B	6	12	27	12	14	8
114005.B	8	14	29	12	17	8
114006.B	10	15	30	14	19	8
114007.B	12	17	32	17	22	8
114008.B	15	21	36	19	27	8
114009.B	18	23,5	40	24	32	8