

## Deviazione a Y: Tipo 89

### SPECIFICHE TECNICHE

<b>Materiale</b>	AISI 316 / 1.4401 / 1.4408
<b>Filettatura</b>	EN 10226-1 (ex ISO 7/1)
<b>Rating</b>	150 PSI - PN10

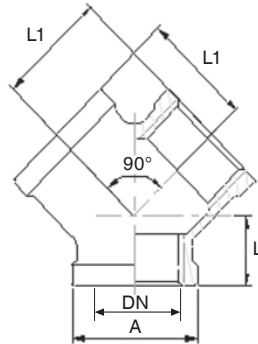

Codice	DN	DN (inch)	A (mm)	L (mm)	L1 (mm)	Peso (gr)
089108316	6	1/8"	17	10	17	40
089104316	8	1/4"	21	13	19	64
089308316	10	3/8"	25	14	23	100
089102316	15	1/2"	29	18	27	128
089304316	20	3/4"	35	20	32	193
089100316	25	1"	43	23	38	323
089114316	32	1"1/4"	52	28	46	485
089112316	40	1"1/2"	58	30	48	565
089200316	50	2"	71	34	57	890