

## Giunto a 3 pezzi MF: Tipo 341

### SPECIFICHE TECNICHE

**Materiale** AISI 316 / 1.4401 / 1.4408  
**Filettatura** EN 10226-1 (ex ISO 7/1)  
**Rating** 150 PSI – PN10

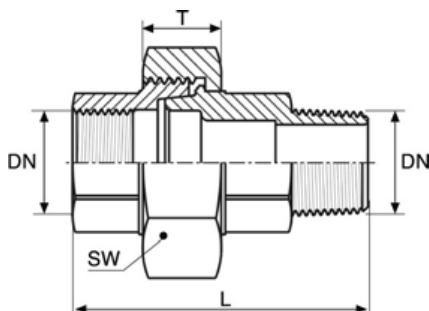

Codice	DN	DN1 (inch)	L (mm)	T (mm)	SW (mm)	Peso (gr)
341108316	6	1/8"	40	13,5	25	59
341104316	8	1/4"	50	13,5	30	108
341308316	10	3/8"	50	15,5	35	133
341102316	15	1/2"	57	17	42	230
341304316	20	3/4"	67	19	47	332
341100316	25	1"	68,3	20,5	53	403
341114316	32	1"1/4	83	23	71	865
341112316	40	1"1/2	86,3	26	78	978
341200316	50	2"	94	28,5	92	1509
341212316	65	2"1/2	113,3	28,5	112	2457
341300316	80	3"	127	30	126	3450
341400316	100	4"	154,3	38	157	5720