

Mezzo manicotto: Tipo 168/316L

SPECIFICHE TECNICHE

Norma	UNI/DIN EN 10241 (ex DIN 2986)
Materiale	AISI 316L / W. 1.4404
Filettatura	EN 10226-1 (ex ISO 7/1)
Rating	150 PSI – PN10

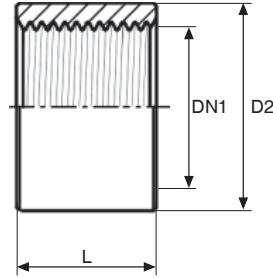

Codice	DN	DN1 (inch)	D2 (mm)	L (mm)	Peso (gr)
168108316	6	1/8"	15	10	9
168104316	8	1/4"	18,5	11	12
168308316	10	3/8"	21,3	12	14
168102316	15	1/2"	26,4	15	27
168304316	20	3/4"	31,8	17	36
168100316	25	1"	39,5	20	58
168114316	32	1"1/4	48,3	22	88
168112316	40	1"1/2	54,5	22	116
168200316	50	2"	69	26	215
168212316	65	2"1/2	87	31	406
168300316	80	3"	100	34	500
168400316	100	4"	126	39	769