

## Portagomma M: Tipo 344

### SPECIFICHE TECNICHE

<b>Materiale</b>	AISI 316 / 1.4401 / 1.4408
<b>Filettatura</b>	EN 10226-1 (ex ISO 7/1)
<b>Rating</b>	150 PSI – PN10

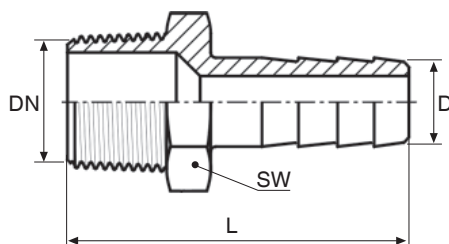

Codice	DN	DN (inch)	D (mm)	L (mm)	SW (mm)	Peso (gr)
344108316	6	1/8"	7	45	12,5	15
344104316	8	1/4"	9	47	16,5	31
344308316	10	3/8"	11	55	20	41
344102316	15	1/2"	13	64	23,5	71
344304316	20	3/4"	16	68	31	139
344100316	25	1"	25	71	38,5	235
344114316	32	1"1/4"	33	80	46	267
344112316	40	1"1/2"	39	95	52	412
344200316	50	2"	51	105	62	692