

Tappo maschio testa quadra: Tipo 291

SPECIFICHE TECNICHE

Materiale AISI 316 / 1.4401 / 1.4408
Filettatura EN 10226-1 (ex ISO 7/1)
Rating 150 PSI - PN10

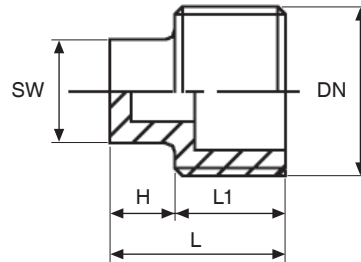

Codice	DN	DN1 (inch)	L (mm)	L1 (mm)	H (mm)	SW (mm)	Peso (gr)
291108316	6	1/8"	16,5	12,5	6,5	7x7	9
291104316	8	1/4"	20	12	8	9x9	17
291308316	10	3/8"	22	13	9	11x11	30
291102316	15	1/2"	25	15,5	9,5	13x13	37
291304316	20	3/4"	27,5	17	10,5	16x16	45
291100316	25	1"	32	20	12	20x20	95
291114316	32	1 1/4"	35	22	13	24x24	137
291112316	40	1 1/2"	37	22	15	25x25	151
291200316	50	2"	39	24	15	32x32	242
291212316	65	2 1/2"	48	30	18	42x42	617
291300316	80	3"	52	34	18	46x46	913
291400316	100	4"	62	39,5	22,5	58x58	1588