

Tronchetto corto spessorato CLAMP AISI 316

Normativa: CLAMP BS

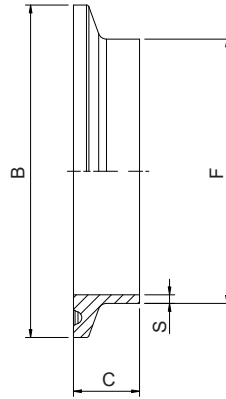

Fig. XC303.11

Codice	DN (inch)	B (mm)	F (mm)	C (mm)	S (mm)
XC303.11025.316	1"	50.4	29.46	41.27	3.68
XC303.11040.316	1" 1/2	50.4	42.57	41.27	3.88
XC303.11050.316	2"	64.0	55.68	44.45	4.09
XC303.11065.316	2" 1/2	77.4	68.78	44.45	4.29
XC303.11080.316	3"	91.0	81.89	46.0	4.49
XC303.11100.316	4"	119.0	108.1	54.0	5.36
XC303.11150.316	6"	167	165.1	54.0	9.11