

GAMMA ACCESSORI COMANDI PNEUMATICI
PNEUMATIC CONTROL ACCESSORIES RANGE

- Accessori **N-FORCE**
N-FORCE accessories pag. 03
- Accessori **MINI-FORCE**
MINI-FORCE accessories pag. 08
- Accessori **N-GAGE2 e N-GAGE3**
N-GAGE2 and N-GAGE3 accessories pag. 10
- Accessori **DEVIATORI PNEUMATICI PROPORZIONALI**
PNEUMATIC CONTROL SWITCH PROPORTIONAL accessories pag. 12
- Raccordi / *Fittings* pag. 15

10000270038



H=50 mm

10000270047

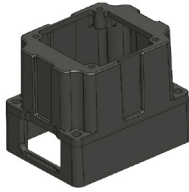

H=80 mm

10000270154

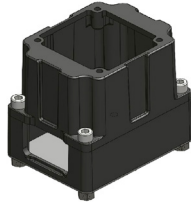

H=88 mm

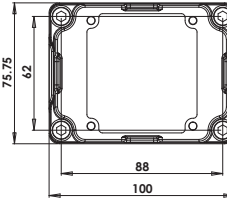

10000270074

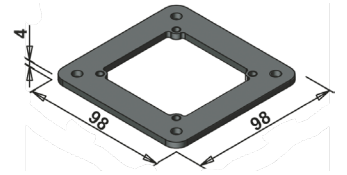

Supporto esterno
External support

Staffa a cruscotto
Flange on dashboard

10000270065

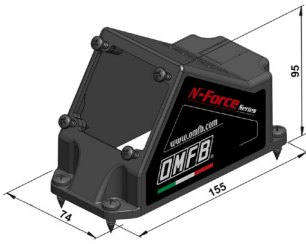

Supporto per il fissaggio esterno. Con questo kit c'è la possibilità di alloggiare un selettore pneumatico per il comando di applicazioni ausiliarie.

Bracket external mounting. With this kit you can also fit a pneumatic switch to control other auxiliary applications.

10000260101

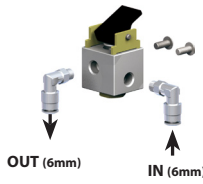

Selettore a 2 vie pneumatico da utilizzarsi con il supporto 10000270065.

2-ways pneumatic switch to be coupled with our bracket P/N 10000270065.

MONTAGGIO
MOUNTING

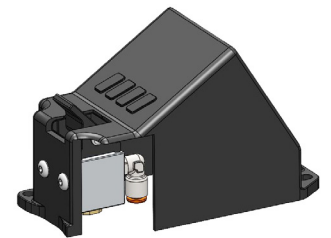

Codice - P/N

Descrizione
Description

10000270181

Maniglione / Handle
Ø 22 mm

10000270056

Maniglione / Handle
Ø 25 mm

Kit fissaggio N-Force a maniglione cabina
Fixing N-FORCE kit to cabin handle
FISSO / FIXED

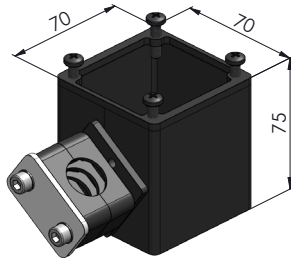

Codice - P/N

Descrizione
Description

10000270627

Maniglione / Handle
Ø 22 mm

10000270636

Maniglione / Handle
Ø 25 mm

Kit fissaggio N-Force a maniglione cabina
Fixing N-FORCE kit to cabin handle
ORIENTABILE / ADJUSTABLE

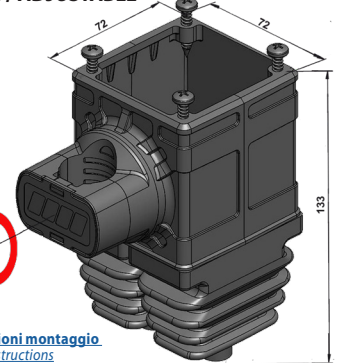

Collegamenti / Link:
[Scheda tecnica / Istruzioni montaggio](#)
[Data sheet / Mounting instructions](#)

Codice - P/N

Descrizione
Description

10000270029

Kit supporto N-Force H=80+raccordi 1/8 tubo 6
Bracket kit for N-Force control H=80+1/8 pipe 6 fittings

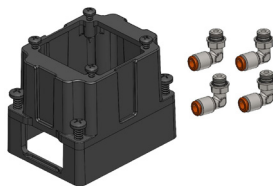

Codice - P/N

Descrizione
Description

10000270163

Supporto per il fissaggio esterno con foro posteriore
passaggio tubi.
Bracket external mounting with rear hole fore pipe.

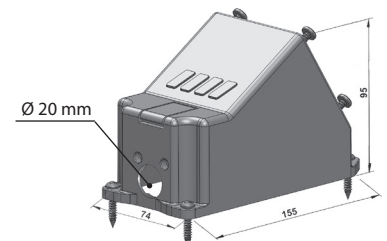

Codice - P/N

Descrizione
Description

10000260156

Kit segnalatore elettrico di pressione.
Pressure signal switch assembly.



DAF

Codice - P/N	Descrizione Description
10000270172	Supporto inclinato N-Force con staffa per DAF XF Bracket kit for N-Force for DAF XF

 **Collegamenti / Link:**
[Scheda tecnica / Istruzioni montaggio](#)
[Data sheet / Mounting instructions](#)

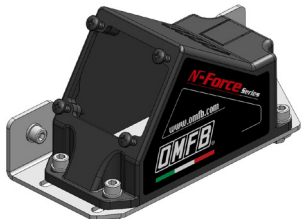

Codice - P/N	Descrizione Description
10000270225	Kit supporto N-Force per DAF CF 85 Bracket kit for N-Force for DAF CF 85

 **Collegamenti / Link:**
[Scheda tecnica / Istruzioni montaggio](#)
[Data sheet / Mounting instructions](#)

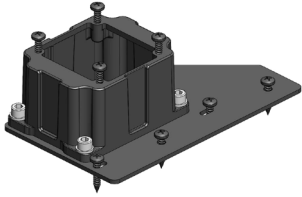

Codice - P/N	Descrizione Description
10000270243	Supporto inclinato N-Force con staffa per DAF XF (2012) Bracket kit for N-Force for DAF XF (2012)

 **Collegamenti / Link:**
[Scheda tecnica / Istruzioni montaggio](#)
[Data sheet / Mounting instructions](#)



Codice - P/N	Descrizione Description
10000270332	Supporto inclinato N-Force + staffa per DAF XF 2016/04 Bracket kit for N-Force + bracket installation on DAF XF 2016/14

 **Collegamenti / Link:**
[Scheda tecnica / Istruzioni montaggio](#)
[Data sheet / Mounting instructions](#)



SCANIA

Codice - P/N	Descrizione Description
10000270305	Supporto inclinato N-Force per SCANIA E6 serie R-S (Trattore 2-3 assi - supporto sedile aperto) Bracket kit for N-Force installation on SCANIA E6 R-S series (2/3-axles Tractor - driver seat with open bottom cover)

 **Collegamenti / Link:**
[Scheda tecnica / Istruzioni montaggio](#)
[Data sheet / Mounting instructions](#)

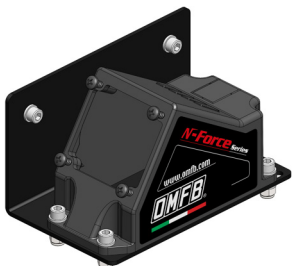

Codice - P/N	Descrizione Description
10000270378	Supporto inclinato - 2^ serie - N-Force per SCANIA E6 SERIE R-S (Trattore a 2 assi - supporto sedile chiuso) Bracket kit - 2nd series - for N-Force installation on SCANIA E6 R-S Series (2-axles Tractor - driver seat with closed bottom cover)

 **Collegamenti / Link:**
[Scheda tecnica / Istruzioni montaggio](#)
[Data sheet / Mounting instructions](#)

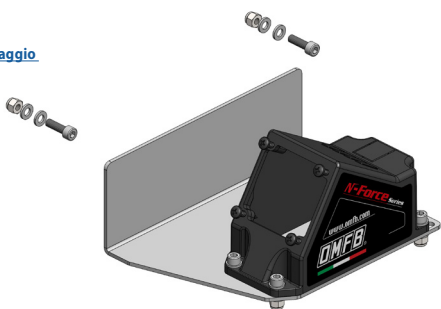

Codice - P/N	Descrizione Description
10000270467	Supporto inclinato N-Force + staffa per SCANIA Angled bracket for N-Force c/w plate for SCANIA

 **Collegamenti / Link:**
[Scheda tecnica / Istruzioni montaggio](#)
[Data sheet / Mounting instructions](#)

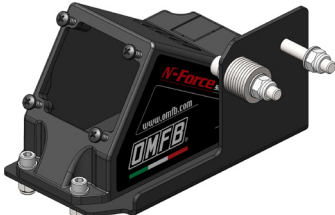

IVECO

Codice - P/N	Descrizione Description
10000270449	Kit montaggio N-Force - IVECO SWAY - Bracket kit for N-Force - IVECO SWAY -

 [Collegamenti / Link:](#)
[Scheda tecnica / Istruzioni montaggio](#)
[Data sheet / Mounting instructions](#)



Codice - P/N	Descrizione Description
10000270574	Kit montaggio N-Force - IVECO SWAY/2 - Bracket kit for N-Force - IVECO SWAY/2 -

 [Collegamenti / Link:](#)
[Scheda tecnica / Istruzioni montaggio](#)
[Data sheet / Mounting instructions](#)



Codice - P/N	Descrizione Description
10000270734	Kit montaggio N-Force - IVECO SWAY NG.09/24 Bracket kit for N-Force - IVECO SWAY NG.09/24

 [Collegamenti / Link:](#)
[Scheda tecnica / Istruzioni montaggio](#)
[Data sheet / Mounting instructions](#)

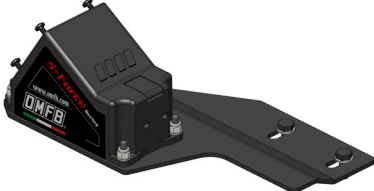

MAN

Codice - P/N	Descrizione Description
10000270234	Kit supporto N-Force per MAN TGX-TGS Bracket kit for N-Force for MAN TGX-TGS

 [Collegamenti / Link:](#)
[Scheda tecnica / Istruzioni montaggio](#)
[Data sheet / Mounting instructions](#)

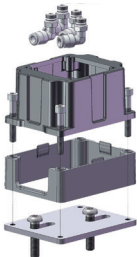

Codice - P/N	Descrizione Description
10000270289	Kit supporto N-Force EVO per MAN TGX-TGS cabina alta e bassa Bracket kit for N-Force EVO to suit MAN TGX/TGS low and high cabin

 [Collegamenti / Link:](#)
[Scheda tecnica / Istruzioni montaggio](#)
[Data sheet / Mounting instructions](#)

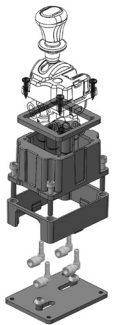

Codice - P/N	Descrizione Description
10000270369	Kit supporto N-Force e pulsantier: MAN 3 ASSI MD N-Force bracket + push button control on MAN 3 axles MD

 [Collegamenti / Link:](#)
[Scheda tecnica / Istruzioni montaggio](#)
[Data sheet / Mounting instructions](#)

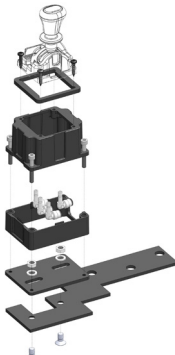

Codice - P/N	Descrizione Description
13590101067	Piastra fissaggio N-Force per tunnel MAN TGX-TGS Plate N-Force for tunnel MAN TGX-TGS

 [Collegamenti / Link:](#)
[Scheda tecnica / Istruzioni montaggio](#)
[Data sheet / Mounting instructions](#)

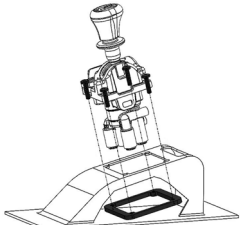

VOLVO

Codice - P/N	Descrizione Description
10000270252	Supporto inclinato N-Force con staffa per VOLVO FH <i>Bracket kit for N-Force for VOLVO FH</i>



Collegamenti / Link:
[Scheda tecnica / Istruzioni montaggio](#)
Data sheet / Mounting instructions



Codice - P/N	Descrizione Description
10000270341	Supporto inclinato N-Force + staffa per VOLVO FH 2016/04 <i>Angled bracket for N-Force c/w plate for VOLVO FH 2016/04</i>



Collegamenti / Link:
[Scheda tecnica / Istruzioni montaggio](#)
Data sheet / Mounting instructions



Codice - P/N	Descrizione Description
10000270672	Staffa supporto M/N-FORCE VOLVO ELECTRIC <i>Bracket for M/N-FORCE for VOLVO ELECTRIC</i>



Collegamenti / Link:
[Scheda tecnica / Istruzioni montaggio](#)
Data sheet / Mounting instructions



Codice - P/N	Descrizione Description
10000270681	Supporto inclinato N-FORCE+Staffa VOLVO FH 2023/10 <i>Angled bracket for N-FORCE air control C/W plate for VOLVO FH 2023/10</i>



Collegamenti / Link:
[Scheda tecnica / Istruzioni montaggio](#)
Data sheet / Mounting instructions



FORD

Codice - P/N	Descrizione Description
10000270565	Kit distanziale cabina FORD FORD cabin spacer kit

Collegamenti / Link:
[Scheda tecnica / Istruzioni montaggio](#)
[Data sheet / Mounting instructions](#)

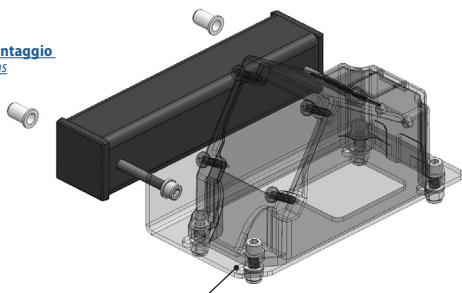

Kit 10000270458

Codice - P/N	Descrizione Description
10000270458	Supporto inclinato N-Force +staffa per FORD Angled bracket for N-Force c/w plate for FORD

Collegamenti / Link:
[Scheda tecnica / Istruzioni montaggio](#)
[Data sheet / Mounting instructions](#)



MERCEDES

Codice - P/N	Descrizione Description
10000270323	Supporto N-Force EVO con staffa per MERCEDES EURO 6 Bracket kit for N-Force EVO for MERCEDES EURO 6

Collegamenti / Link:
[Scheda tecnica / Istruzioni montaggio](#)
[Data sheet / Mounting instructions](#)



Codice - P/N	Descrizione Description
10000270592	Kit distanziale cabina MERCEDES MERCEDES cabin spacer kit

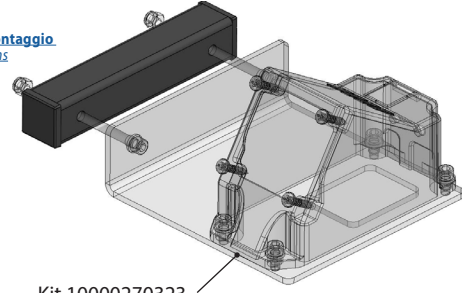

Collegamenti / Link:
[Scheda tecnica / Istruzioni montaggio](#)
[Data sheet / Mounting instructions](#)



Kit 10000270323

RENAULT

Codice - P/N	Descrizione Description
10000270298	Kit supporto inclinato per N-Force su RENAULT T Bracket kit for N-Force for RENAULT T

Collegamenti / Link:
[Scheda tecnica / Istruzioni montaggio](#)
[Data sheet / Mounting instructions](#)



1000270556
Staffa quadra con viti
Bracket with screws

N°4 Viti/Screws
TCE M3x16 UNI 5931

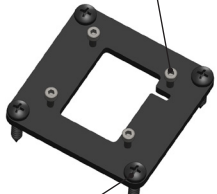

N°4 Viti ATF/Screws
4.8x25 ISO 7049

Staffa abbinabile a ...
Bracket, to be combined with ...

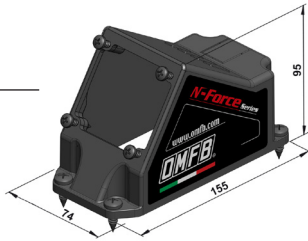

1000270065
Supporto fissaggio esterno
Bracket external mounting

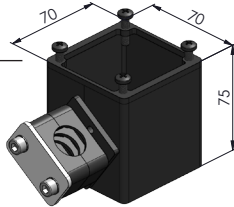

FISSO / FIXED

1000270181
Maniglione
Handle Ø 22 mm

1000270056
Maniglione
Handle Ø 25 mm

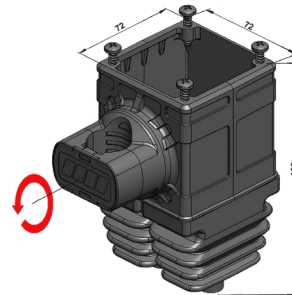

**ORIENTABILE
ADJUSTABLE**

1000270627
Maniglione
Handle Ø 22 mm

1000270636
Maniglione
Handle Ø 25 mm

Collegamenti / Link:
[Scheda tecnica / Istruzioni montaggio](#)
[Data sheet / Mounting instructions](#)

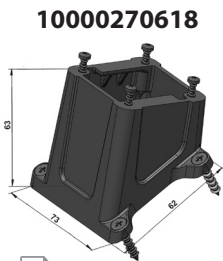

1000270618

H=50 mm



1000270038

H=80 mm

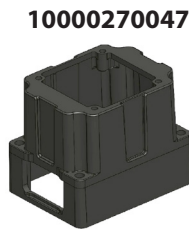

1000270047

H=88 mm



1000270154



Collegamenti / Link:
[Scheda tecnica / Istruzioni montaggio](#)
[Data sheet / Mounting instructions](#)

SCANIA

Codice - P/N	Descrizione Description
1000270501	Kit plancia MINI-FORCE + ausiliario SCANIA. MINI-FORCE fixation plate + aux. option for SCANIA.

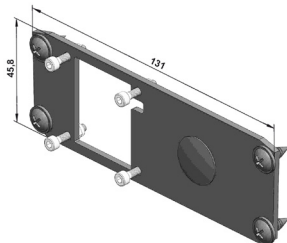

VOLVO - RENAULT

Codice - P/N	Descrizione Description
1000270529	Kit plancia MINI-FORCE + ausiliario VOLVO/RENAULT. MINI-FORCE fixation plate + aux. option for VOLVO/RENAULT.

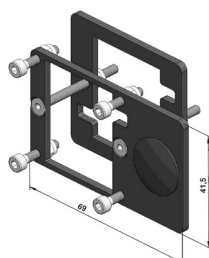

MAN

Codice - P/N	Descrizione Description
1000270725	Kit piastra montaggio MINI-FORCE - MAN TG3.06/24. Mounting plate for MINI-FORCE - MAN TG3.06/24.



Collegamenti / Link:
[Scheda tecnica / Istruzioni montaggio](#)
[Data sheet / Mounting instructions](#)

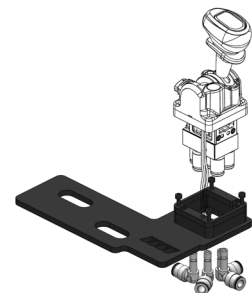

Codice - P/N	Descrizione Description
13590101058	Piastra fissaggio N-Force per tunnel MAN TGX-TGS Plate N-Force for tunnel MAN TGX-TGS



Collegamenti / Link:
[Scheda tecnica / Istruzioni montaggio](#)
[Data sheet / Mounting instructions](#)

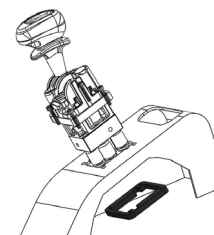

IVECO

Codice - P/N	Descrizione Description
10000270752	Kit montaggio MINI-Force - IVECO SWAY NG.09/24 Bracket kit for MINI-Force - IVECO SWAY NG.09/24



Collegamenti / Link:
[Scheda tecnica / Istruzioni montaggio](#)
[Data sheet / Mounting instructions](#)



DAF

Codice - P/N	Descrizione Description
10000270770	Kit montaggio MINI-Force - DAF NGD LGDX Bracket kit for MINI-Force - DAF NGD LGDX



Collegamenti / Link:
[Scheda tecnica / Istruzioni montaggio](#)
[Data sheet / Mounting instructions](#)

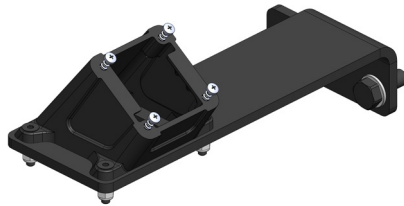

Codice - P/N	Descrizione Description
10000270789	Staffa montaggio MINI-Force su maniglione Ø22mm per DAF NGD Orientable support for mounting the Mini-Force cab control on handle bar 22mm diameter



Collegamenti / Link:
[Scheda tecnica / Istruzioni montaggio](#)
[Data sheet / Mounting instructions](#)



Codice - P/N	Descrizione Description
10000270109	Kit piastra quadra fissaggio n°2 posizioni per N-GAGE 2 2-ways square fixing plate kit for N-GAGE2

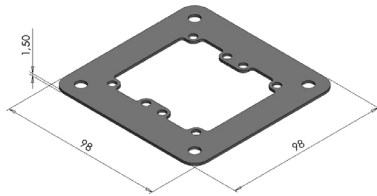

Codice - P/N	Descrizione Description
10000270118	Kit piastra rettangolare fissaggio n°3 posizioni per N-GAGE 2 3-ways square fixing plate kit for N-GAGE2

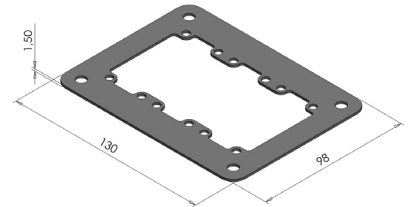

Codice - P/N	Descrizione Description
10000270127	Kit supporto fissaggio n°1 posizione N-GAGE2 1-way mounting bracket kit for N-GAGE2

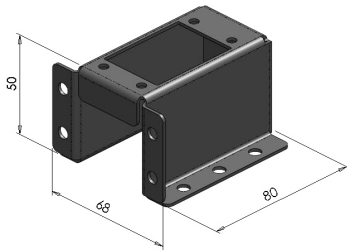

Codice - P/N	Descrizione Description
10000270136	Kit supporto fissaggio n°2 posizioni N-GAGE2 2-ways mounting bracket kit for N-GAGE2

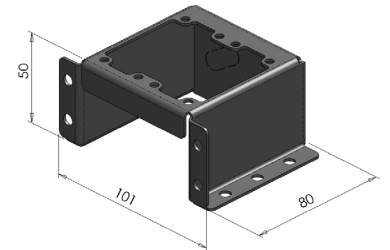

Codice - P/N	Descrizione Description
10000270145	Kit supporto fissaggio n°3 posizioni N-GAGE2 3-way mounting bracket kit for N-GAGE2

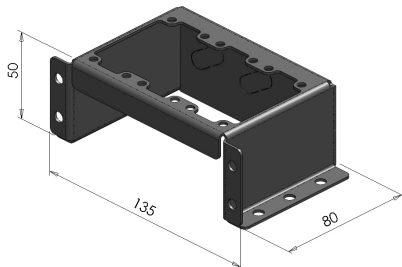

Codice - P/N	Descrizione Description
10000270092	Kit staffa Bracket kit

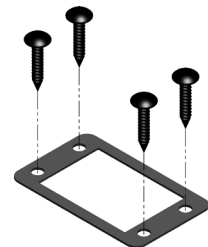

Codice - P/N	Descrizione Description
10000270190	Kit supporto fissaggio n°1 posizione N-GAGE3 <i>1-way mounting bracket kit for N-GAGE3</i>

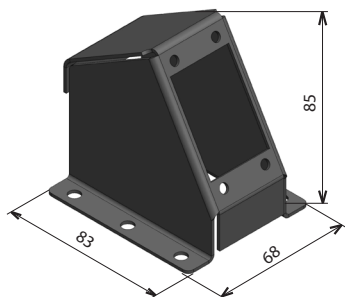

Codice - P/N	Descrizione Description
10000270207	Kit supporto fissaggio n°2 posizioni N-GAGE3 <i>2-ways mounting bracket kit for N-GAGE3</i>

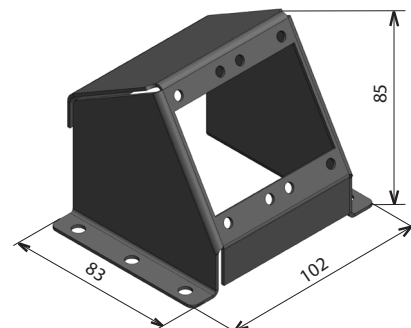

Codice - P/N	Descrizione Description
10000270216	Kit supporto fissaggio n°3 posizioni N-GAGE3 <i>3-way mounting bracket kit for N-GAGE3</i>

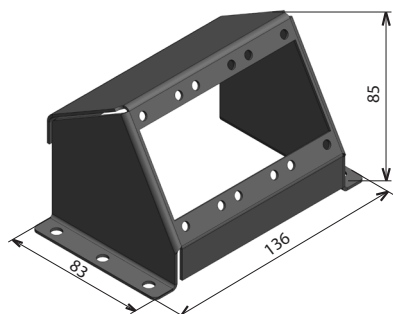

DAF

Codice - P/N	Descrizione Description
10000240016	Kit supporto deviatore pneumatico componibile per DAF XF 105 Bracket kit for sandwich air switch for DAF XF 105



Collegamenti / Link:
[Scheda tecnica / Istruzioni montaggio](#)
[Data sheet / Mounting instructions](#)

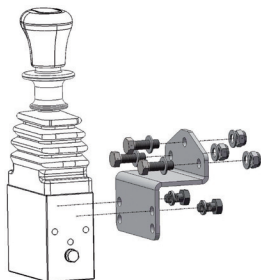

Codice - P/N	Descrizione Description
10000240025	Kit supporto deviatore pneumatico componibile per DAF XF (2012) Bracket kit for sandwich air switch for DAF XF (2012)



Collegamenti / Link:
[Scheda tecnica / Istruzioni montaggio](#)
[Data sheet / Mounting instructions](#)

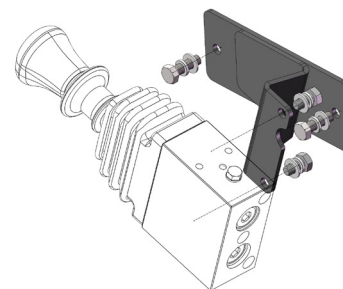

Codice - P/N	Descrizione Description
10000240034	Kit supporto deviatore pneumatico componibile per DAF CF EURO-5 Bracket kit for sandwich air switch for DAF CF EURO-5



Collegamenti / Link:
[Scheda tecnica / Istruzioni montaggio](#)
[Data sheet / Mounting instructions](#)

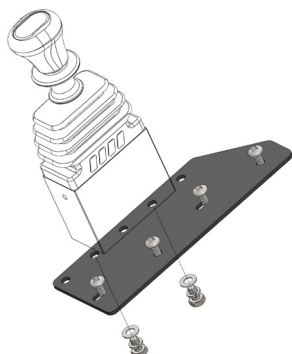

Codice - P/N	Descrizione Description
10000240043	Kit supporto deviatore pneumatico componibile per DAF CF EURO-6 Bracket kit for sandwich air switch for DAF CF EURO-6



Collegamenti / Link:
[Scheda tecnica / Istruzioni montaggio](#)
[Data sheet / Mounting instructions](#)

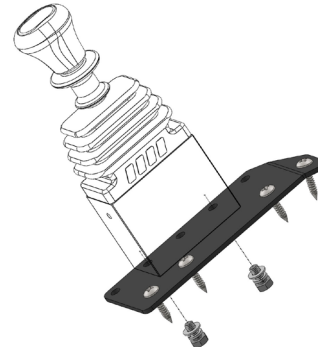

Codice - P/N	Descrizione Description
10000240070	Kit supporto n° 2 deviatori componibili 4/3 per DAF XF (2012) Bracket kit for 2 sandwich control switches for DAF XF (2012)



Collegamenti / Link:
[Scheda tecnica / Istruzioni montaggio](#)
[Data sheet / Mounting instructions](#)

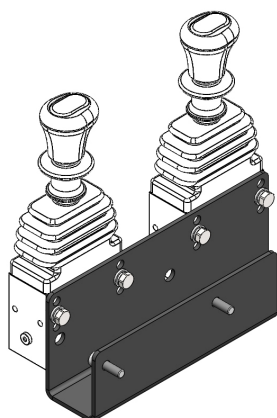

Codice - P/N	Descrizione Description
10000240089	Kit supporto deviatore 4/3 barra Ø22 per DAF XF/XG Bracket kit for sandwich air switch 4/3 handle Ø22 for DAF XF/XG



Collegamenti / Link:
[Scheda tecnica / Istruzioni montaggio](#)
[Data sheet / Mounting instructions](#)

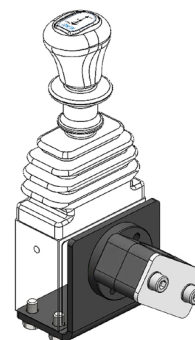

Codice - P/N	Descrizione <i>Description</i>
10000240098	Kit supporto deviatore 4/3 barra Ø25 for DAF XF/XG Bracket kit for sandwich air switch 4/3 handle Ø25 for DAF XF/XG



Collegamenti / Link:
[Scheda tecnica / Istruzioni montaggio](#)
[Data sheet / Mounting instructions](#)

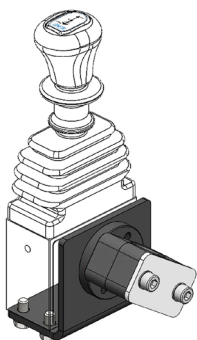

MERCEDES

Codice - P/N	Descrizione <i>Description</i>
10000270609	Kit supporto deviatore pneumatico componibile per MERCEDES ACTROS Bracket kit for sandwich air switch for MERCEDES ACTROS



Collegamenti / Link:
[Scheda tecnica / Istruzioni montaggio](#)
[Data sheet / Mounting instructions](#)

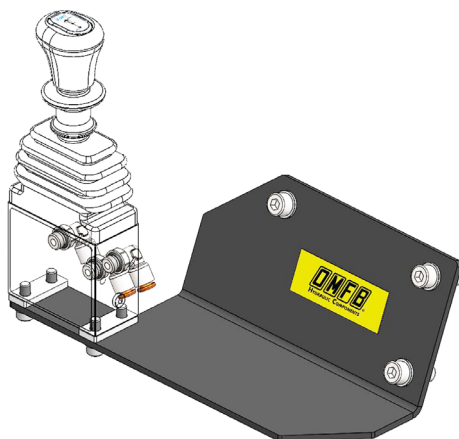

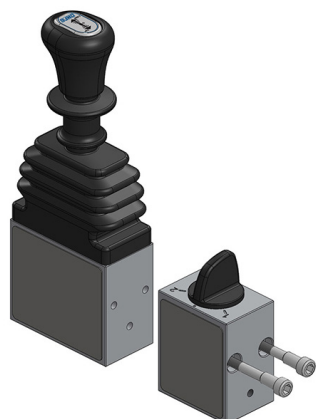

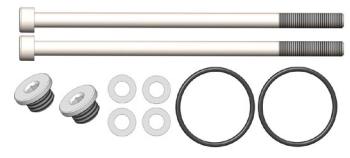

10000280018 Kit montaggio 1 sezione supplementare 1 extra section mounting kit		
10099000028	Tappo G1/8 aria con OR G1/8 air plug with OR	1
50100700037	Rondella piana per M5 Washer for M5	4
50200100406	Vite TCE M5x55 UNI 5931 Screw TCE M5x55 UNI 5931	2
50600100202	Guarnizione O-R 2087 OR washer 2087	1

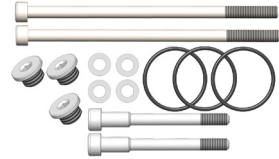

10000280027 Kit montaggio 2 sezioni supplementari 2 extra sections mounting kit		
10099000028	Tappo G1/8 aria con OR G1/8 air plug with OR	2
50100700037	Rondella piana per M5 Washer for M5	4
50200100559	Vite TCE M5x105 UNI 5931 Screw TCE M5x105 UNI 5931	2
50600100202	Guarnizione O-R 2087 OR washer 2087	2

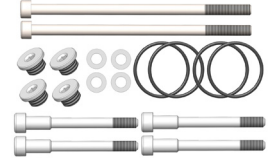

10000280036 Kit montaggio 3 sezioni supplementari 3 extra sections mounting kit		
10099000028	Tappo G1/8 aria con OR G1/8 air plug with OR	3
50100700037	Rondella piana per M5 Washer for M5	4
50200100559	Vite TCE M5x105 UNI 5931 Screw TCE M5x105 UNI 5931	2
50600100202	Guarnizione O-R 2087 OR washer 2087	3
50200000818	Vite TCE speciale M5x53,5 Special screw TCE M5x53,5	2





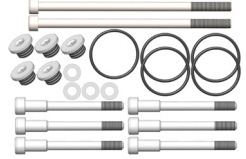



10000280045 Kit montaggio 4 sezioni supplementari 4 extra sections mounting kit		
10099000028	Tappo G1/8 aria con OR G1/8 air plug with OR	4
50100700037	Rondella piana per M5 Washer for M5	4
50200100559	Vite TCE M5x105 UNI 5931 Screw TCE M5x105 UNI 5931	2
50600100202	Guarnizione O-R 2087 OR washer 2087	4
50200000818	Vite TCE speciale M5x53,5 Special screw TCE M5x53,5	4



10000280054 Kit montaggio 5 sezioni supplementari 5 extra sections mounting kit		
10099000028	Tappo G1/8 aria con OR G1/8 air plug with OR	5
50100700037	Rondella piana per M5 Washer for M5	4
50200100559	Vite TCE M5x105 UNI 5931 Screw TCE M5x105 UNI 5931	2
50600100202	Guarnizione O-R 2087 OR washer 2087	5
50200000818	Vite TCE speciale M5x53,5 Special screw TCE M5x53,5	6

Raccordo <i>Fitting</i>	Automatico con OR <i>Automatic with O-RING</i>
1/8" TUBO 4 1/8" AIR PIPE 4	 10001700124
1/8" TUBO 6 1/8" AIR PIPE 6	 10001700151
1/4" CONICO TUBO 8 1/4" CONICAL AIR PIPE 8	 10001600250
M5 TUBO 4 M5 AIR PIPE 4	 10001700133
M5 TUBO 6 M5 AIR PIPE 6	 10001700142M
M12x1.5 TUBO 6 M12x1.5 AIR PIPE 6	 10001600045
1/8" TUBO 4 1/8" AIR PIPE 4	 10001700197
1/8" TUBO 6 1/8" AIR PIPE 6	 10001700188
1/4" TUBO 6 1/4" AIR PIPE 6	 10001700375
1/4" TUBO 8 1/4" AIR PIPE 8	 10001600269
M5 TUBO 4 M5 AIR PIPE 4	 10001700213
1/8" TUBO 6 1/8" AIR PIPE 6	 $\varnothing 12$ 10090000197

RACCORDO <i>Fitting</i>	A calzamento e filetto conico <i>Conical fitting</i>
1/8" TUBO 6 1/8" AIR PIPE 6	 10001600018
M12x1.25 TUBO 6 M12x1.25 AIR PIPE 6	 10000600029
1/8" TUBO 6 1/8" AIR PIPE 6	 10001600027
M12x1.25 TUBO 6 M12x1.25 AIR PIPE 6	 10001200012
M12x1.5 TUBO 6 M12x1.5 AIR PIPE 6	 10001200021
INTERMEDIO TUBO 6 INTERMEDIATE AIR PIPE 6	 10001100013
INTERMEDIO "T" TUBO 6 INTERMEDIATE TEE AIR PIPE 6	 10001400010

RACCORDO <i>Fitting</i>	A calzamento e filetto cilindrico+OR <i>Cylinder fitting+OR</i>
M6 TUBO 6 M6 AIR PIPE 6	 10001600036

RACCORDO Fitting	Automatic Automatic	RACCORDO Fitting	Automatic Automatic
1/8" CONICO TUBO 4 1/8" CONICAL AIR PIPE 4	 10001700115	"Y" TUBO 6 "Y" AIR PIPE 6	 10001700062
M12x1.25 CONICO TUBO 6 M12x1.25 CONICAL AIR PIPE 6	 10001700017	RIDUZIONE TUBO 6 - 4 REDUCTION AIR PIPE 6 - 4	 10001700259
FEMMINA 1/8" TUBO 6 FEMALE 1/8" AIR PIPE 6	 10001600134	RIDUZIONE TUBO 8 - 6 REDUCTION AIR PIPE 8 - 6	 10001700268
1/8" CONICO TUBO 4 1/8" CONICAL AIR PIPE 4	 10001700179	M5 - TUBO 1/4" (6.35mm) M5 - AIR PIPE 1/4" (6.35mm)	 10001790162
1/8" CONICO TUBO 6 1/8" CONICAL AIR PIPE 6	 10001600125	1/8" - TUBO 1/4" (6.35mm) 1/8" - AIR PIPE 1/4" (6.35mm)	 10001790144
1/8" CONICO TUBO 8 1/8" CONICAL AIR PIPE 8	 10001600143	1/8" - TUBO 1/4" (6.35mm) 1/8" - AIR PIPE 1/4" (6.35mm)	 10001790153
1/4" CONICO TUBO 6 1/4" CONICAL AIR PIPE 6	 10001600241	90° M/F TUBO 6 90° M/F AIR PIPE 6	 10001700099
M12x1.25 TUBO 6 M12x1.25 AIR PIPE 6	 10001700044	45° M/F TUBO 6 45° M/F AIR PIPE 6	 10001700106
INTERMEDIO TUBO 6 - 90° 90° - INTERMEDIATE AIR PIPE 6	 10001700320	SILENZIATORE Ø 6 SILENCER Ø 6	 10090000240
INTERMEDIO TUBO 6 - 45° 45° - INTERMEDIATE AIR PIPE 6	 10001700339	<p>TUBO ARIA / AIR PIPE 6x4: 10000900017 - Bianco/White 10000900026 - Rosso/Red 10000900035 - Blu/Blue 10000900044 - Verde/Green 10000900053 - Nero/Black</p>  <p>TUBO ARIA / AIR PIPE 4x2: 10000900115 - Nero/Black</p> <p>TUBO ARIA / AIR PIPE 1/4" (6.35mm): 10000910015 - Neutro/Clear 10000910024 - Blu/Blue</p> <p>NYLON</p> <p>TUBO ARIA / AIR PIPE: 4x2: 10001000425 - Nero/Black 6x4: 10001000649 - Nero/Black 10001010647 - Blu/Blue 8x6: 10001000863 - Nero/Black</p> <p>"PA 12" LONG-LIFE</p>	
INTERMEDIO TUBO 6 INTERMEDIATE AIR PIPE 6	 10001700035		
INTERMEDIO MASCHIO Ø6 MALE INTERMEDIATE Ø6	 10001700080		
INTERMEDIO "T" TUBO 6 TEE INTERMEDIATE AIR PIPE 6	 10001700053		
"L" TUBO 6 - 1/8" "L" AIR PIPE 6 - 1/8"	 10001600303		
"T" TUBO 6 - 1/8" TEE AIR PIPE 6 - 1/8"	 10001600312		